

1

2

3

4

A

A

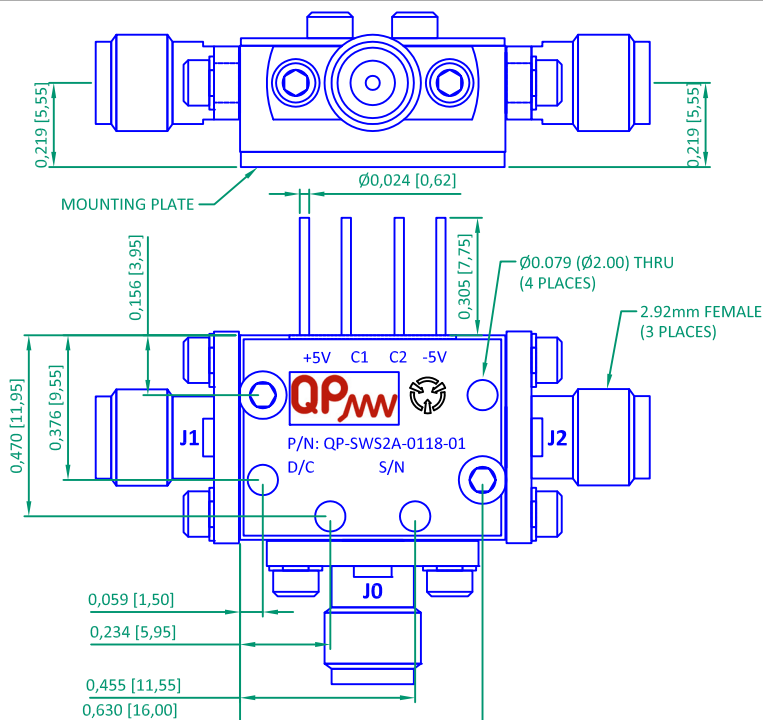
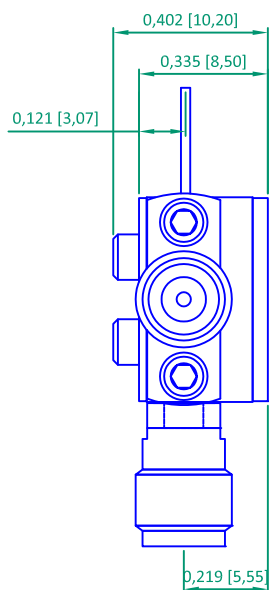

B

B

C

C

**DIMENSIONS APPEAR
AS INCHES (mm).
TOLERANCES APPLY
TO DIMENSIONS IN
INCHES**

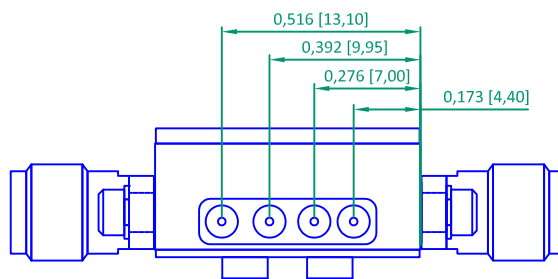

ELECTRICAL SPECIFICATIONS:

FREQUENCY RANGE: 1 - 18 GHz
 INSERTION LOSS: 5.0 dB MAX.
 ISOLATION: 60 dB MIN.
 VSWR: J0: 2.5:1 MAX. J1-J2: 2.5:1 MAX.
 SWITCHING TIME: ON: 25 ns MAX. (50% VCRTL TO 90% RF)
 OFF: 25 ns MAX. (50% VCRTL TO 10% RF)
 CONTROL: TTL See Table
 BIAS: +5V, 50mA. -5V to -15V, 50mA

Ctrl Line		RF Output	
C1	C2	J1	J2
0	0	ON(*)	ON (*)
0	1	ON	OFF
1	0	OFF	ON
1	1	OFF	OFF
N/C	N/C	OFF	OFF

(*) Non Functional
(N/C): Not Connected

D

D

ENVIRONMENTAL RATINGS

- TEMPERATURE: -40°C TO +85°C (OPERATING)
 -55°C TO +125°C (STORAGE)
 - HUMIDITY: MIL-STD-202G, METHOD 103B COND. B
 - SHOCK: MIL-STD-202G, METHOD 213B COND. B
 - VIBRATION: MIL-STD-202G, METHOD 204D COND. B
 - ALTITUDE: MIL-STD-202G, METHOD 105C COND. B
 - TEMP. SHOCK: MIL-STD-202G, METHOD 107D COND. A

E

E



NOTE: The above specifications are subject to change or revision. Specifications are at 25°C unless stated otherwise.

F

F

QP_{mw}

QP microWAVE
 CÔLQUIDE 6
 28230 LAS ROZAS
 MADRID, SPAIN

APPROVALS	DATE	SIGNED	DESCRIPTION: SP2T ABSORTIVO 1 GHz -18 GHz	REV.:	SHEET:
DRAW	20/10/11	JAV	QP-SWS2A-0118-01	001	1 DE 1
CHECKED	20/10/11	JAV			
APPROVED	20/10/11	JAV			

1

2

3

4