

REVISIONS				
ZONE	REV.	DESCRIPTION	DATE	DRAWN

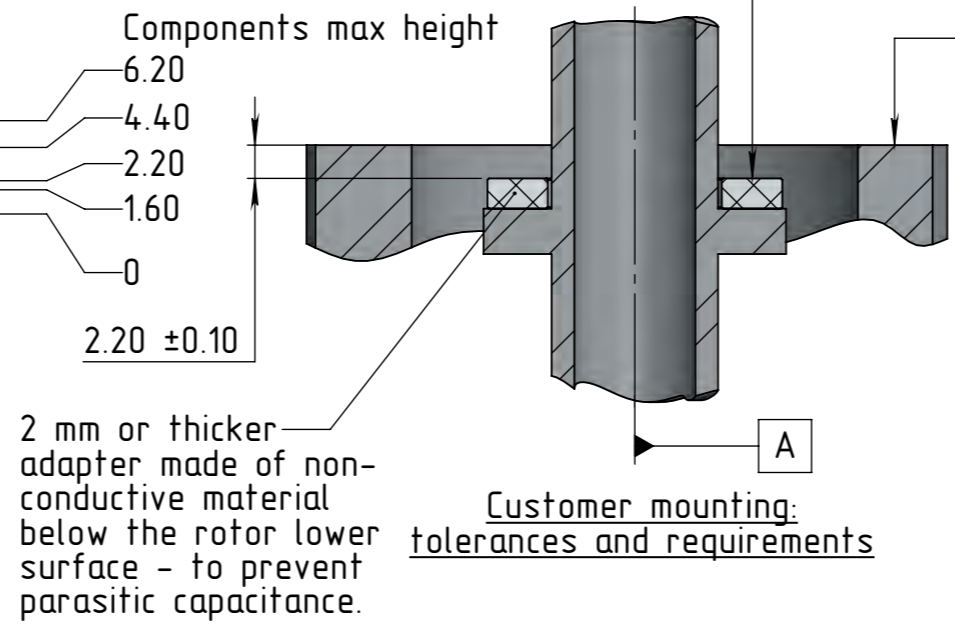

∥	0.05	B
∠	0.05	
⊥	0.05	A
∠	0.05	
		B

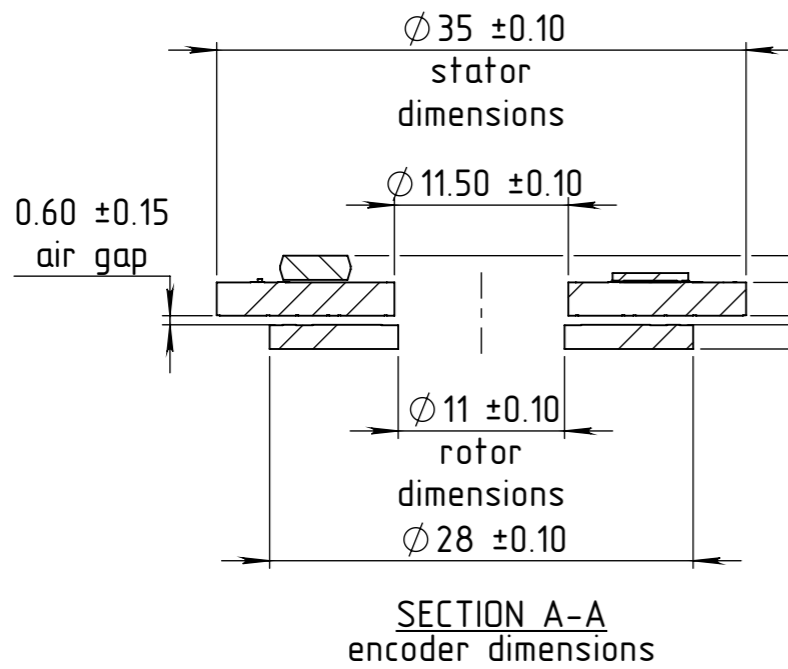
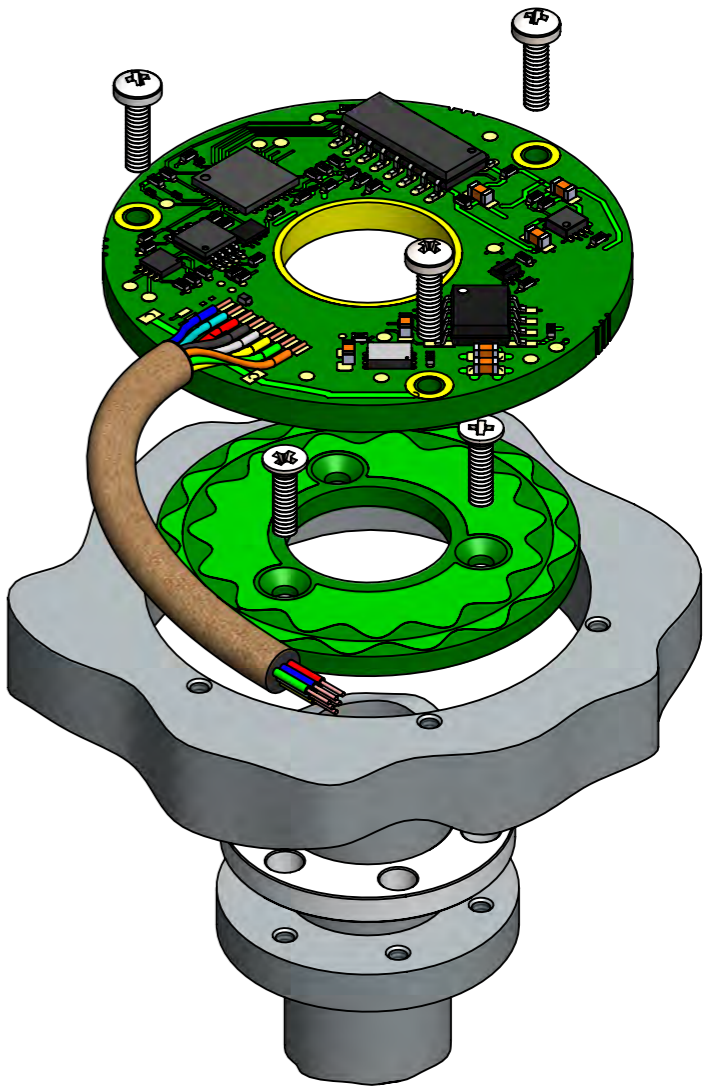

Mounting sample - exploded view

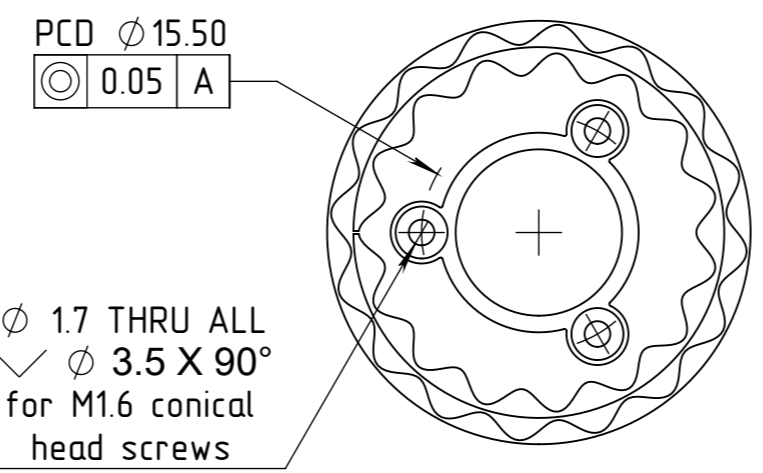
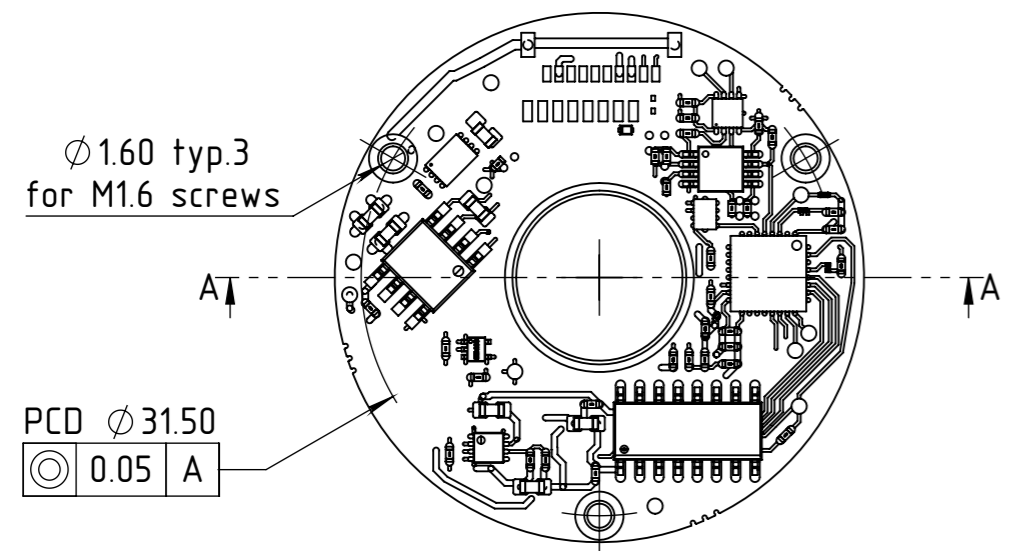

Both stator and rotor are positioned and centered by screws only

The information contained in this drawing is the sole property of Netzer Precision Motion Sensors Ltd. Any reproduction in part or whole without the written permission of Netzer Precision Motion Sensors Ltd. is prohibited. The drawing is confidential, and is the property of Netzer Precision Ltd. It must not be disclosed to a third party without written consent of Netzer Precision Ltd.

NAME	SIGNATURE	DATE	
DRAWN Michael Agam	MA	11-Apr-2024	
CHK'D			
APPV'D			
UNLESS OTHERWISE SPECIFIED:			TITLE: VLP-35-Hollow rotor ICD
DIMENSIONS ARE IN: mm		SURFACE FINISH: N6	MATERIAL:
0.5 - 4.9: ±0.05 mm	5 - 30: ±0.1 mm		Coating:
31 - 120: ±0.15 mm	121 - 400: ±0.2 mm		Revision: 00
401 - 1000: ±0.3 mm	1001 - 2000: ±0.5 mm		A3
Between holes: ±0.05 mm		Angles: ±0.5°	PROJECT: VLP-35
On all edges make chamfer 0.1 mm x 45°			CAT NO.: VLP-35-Hollow rotor ICD

SCALE: 2:1
SHEET 1 OF 1

REVISIONS				
ZONE	REV.	DESCRIPTION	DATE	DRAWN

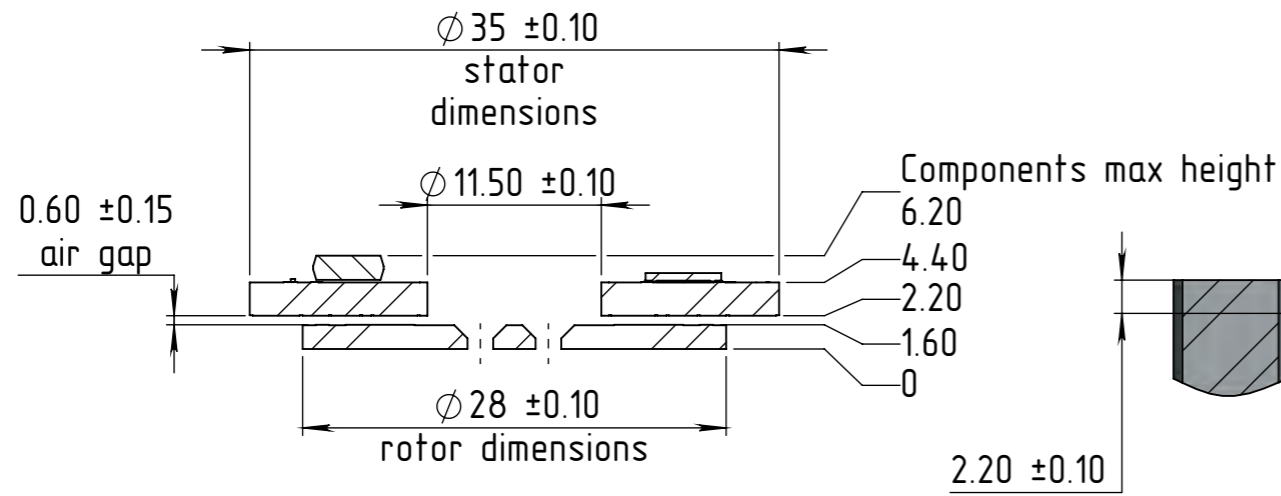

SECTION A-A
encoder dimensions

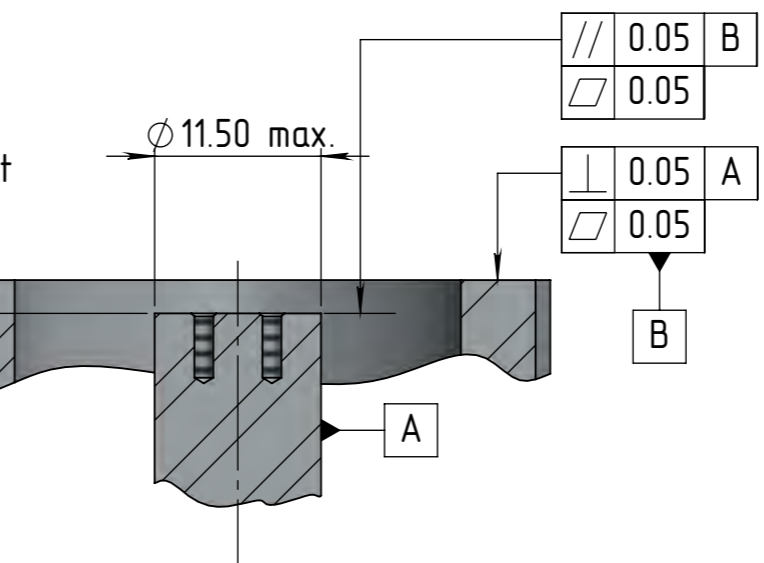

Customer mounting:
tolerances and requirements

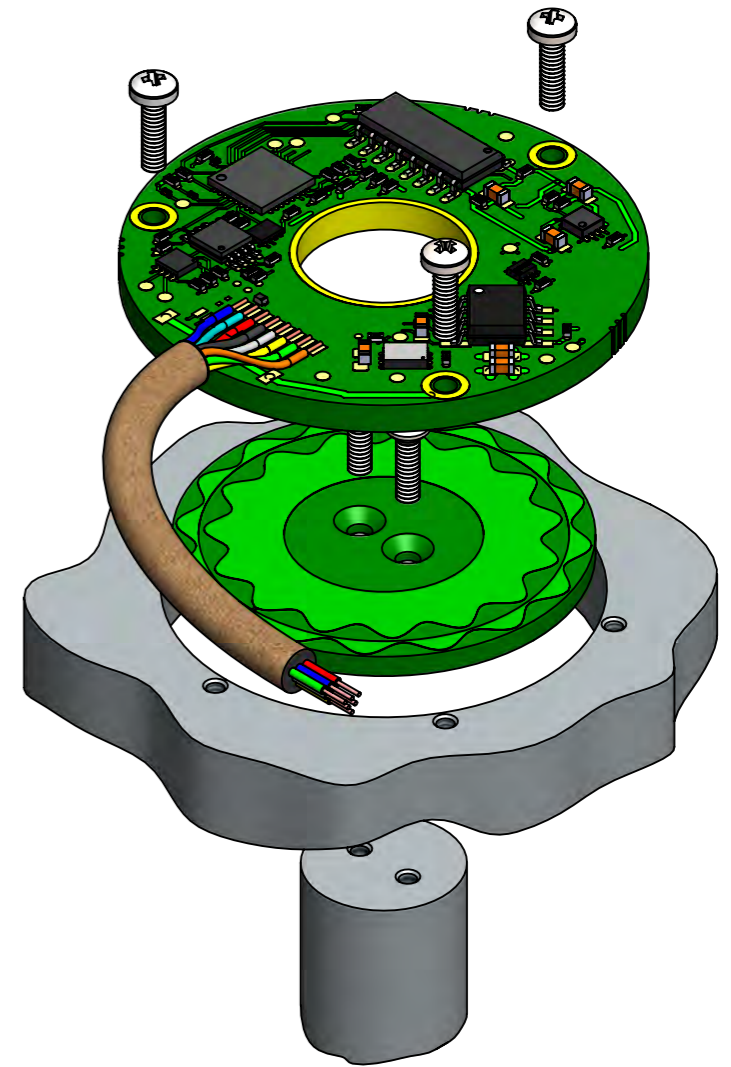

Mounting sample - exploded view

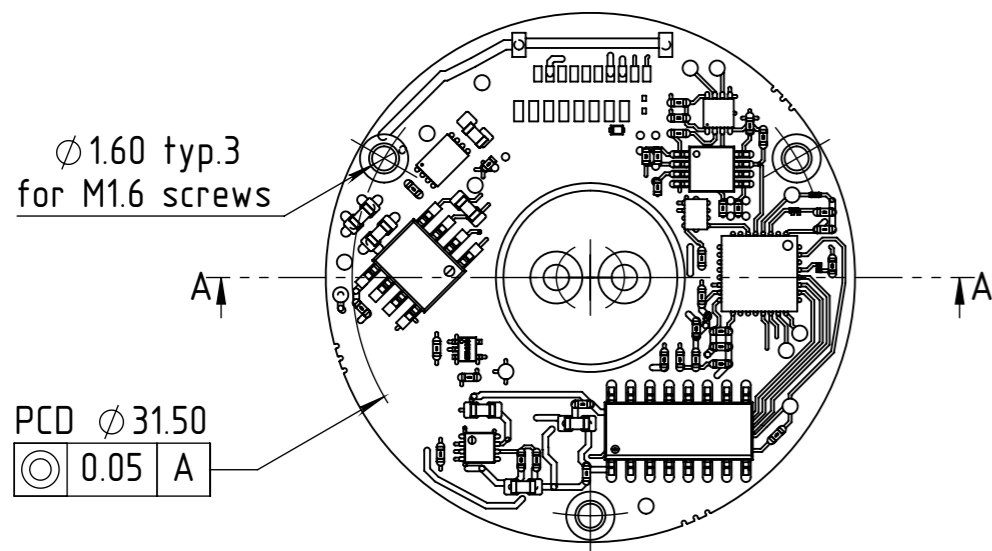

Stator mounting

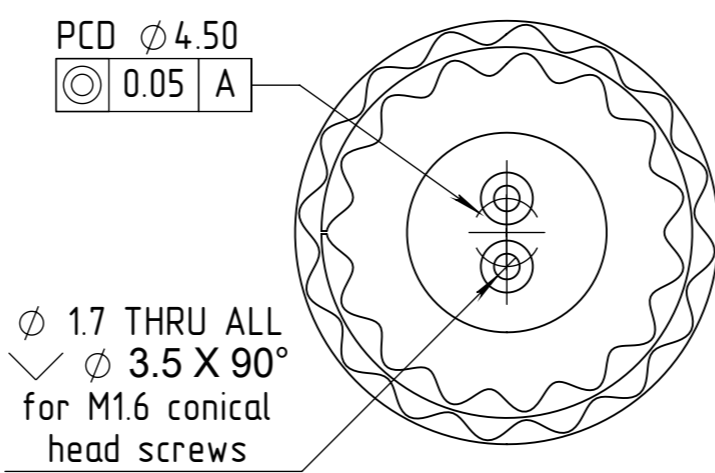

Rotor mounting

Both stator and rotor are positioned
and centered by screws only

The information contained in this drawing is the sole property of Netzer Precision Motion Sensors Ltd. Any reproduction in part or whole without the written permission of Netzer Precision Motion Sensors Ltd. is prohibited. The drawing is confidential, and is the property of Netzer Precision Ltd. It must not be disclosed to a third party without written consent of Netzer Precision Ltd.

NAME	SIGNATURE	DATE	Netzer Precision Position Sensors A.C.S. Ltd.			
DRAWN: Michael Agam	MA	11-Apr-2024	TITLE: VLP-35-Full rotor ICD MATERIAL: PROJECT: VLP-35 CAT NO.: VLP-35-Full rotor ICD			
CHK'D					Coating:	SCALE: 2:1
APPV'D					Revision: 00	A3
UNLESS OTHERWISE SPECIFIED: DIMENSIONS ARE IN: mm SURFACE FINISH: N6 0.5 - 4.9: ±0.05 mm 5 - 30: ±0.1 mm 31 - 120: ±0.15 mm 121 - 400: ±0.2 mm 401 - 1000: ±0.3 mm 1001 - 2000: ±0.5 mm Between holes: ±0.05 mm Angles: ±0.5° On all edges make chamfer 0.1 mm x 45°				SHEET 1 OF 1		

REVISIONS				
ZONE	REV.	DESCRIPTION	DATE	DRAWN

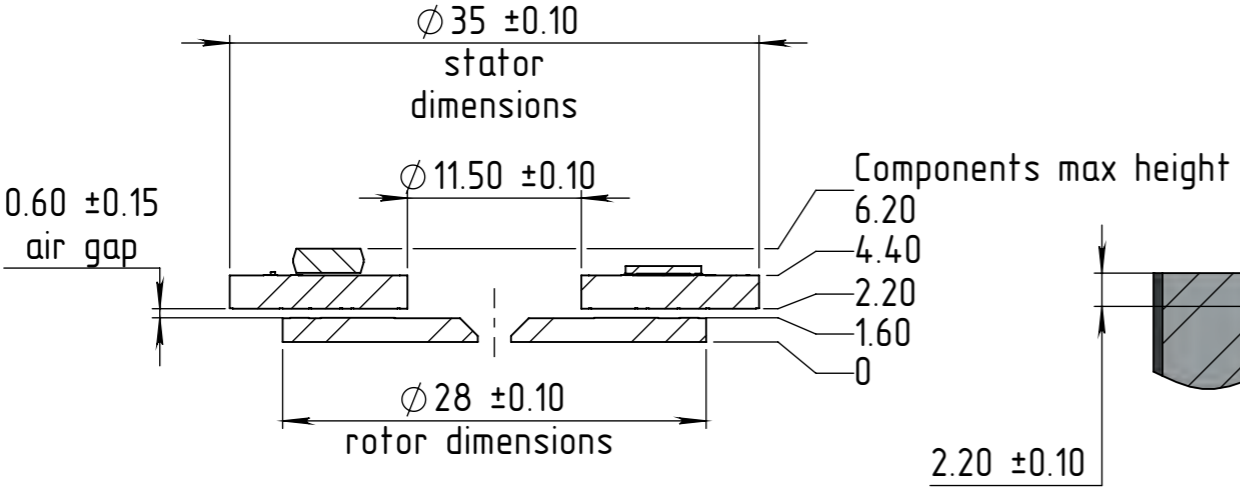

SECTION A-A
encoder dimensions

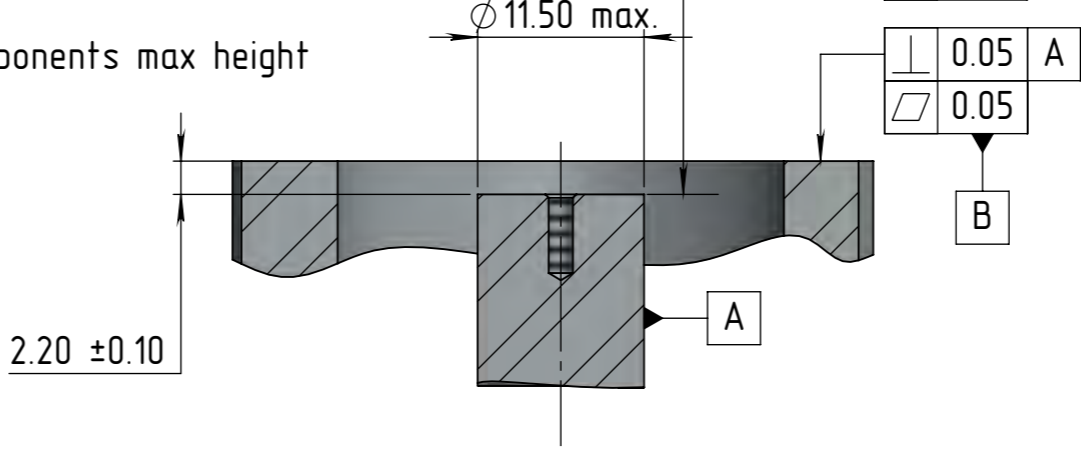

Customer mounting:
tolerances and requirements

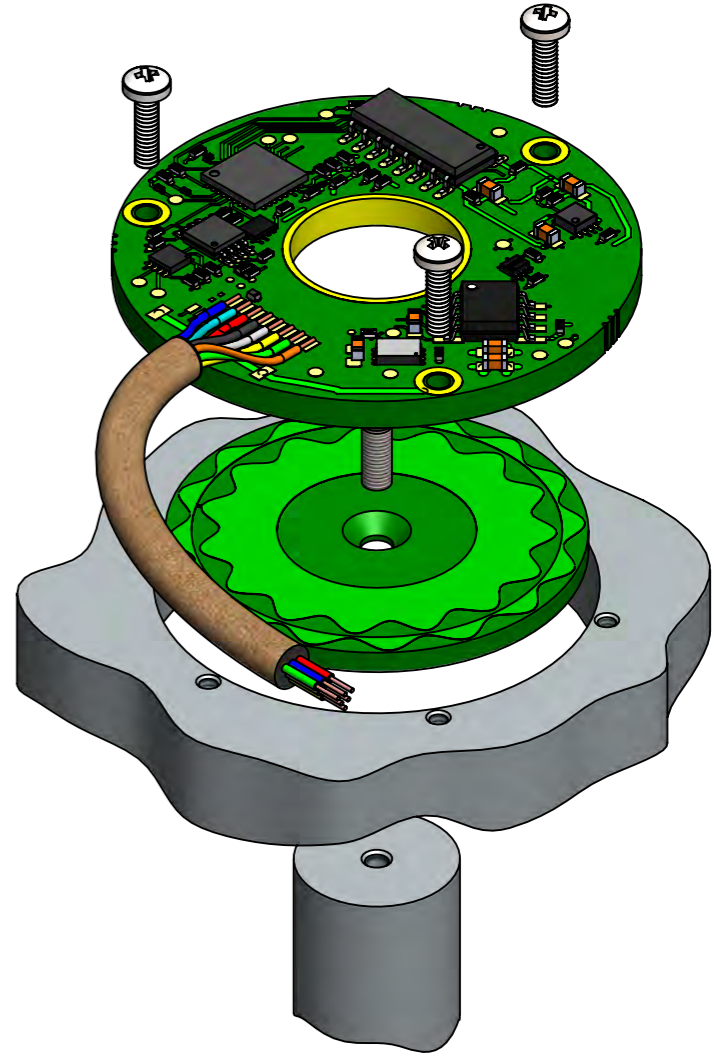

Mounting sample - exploded view

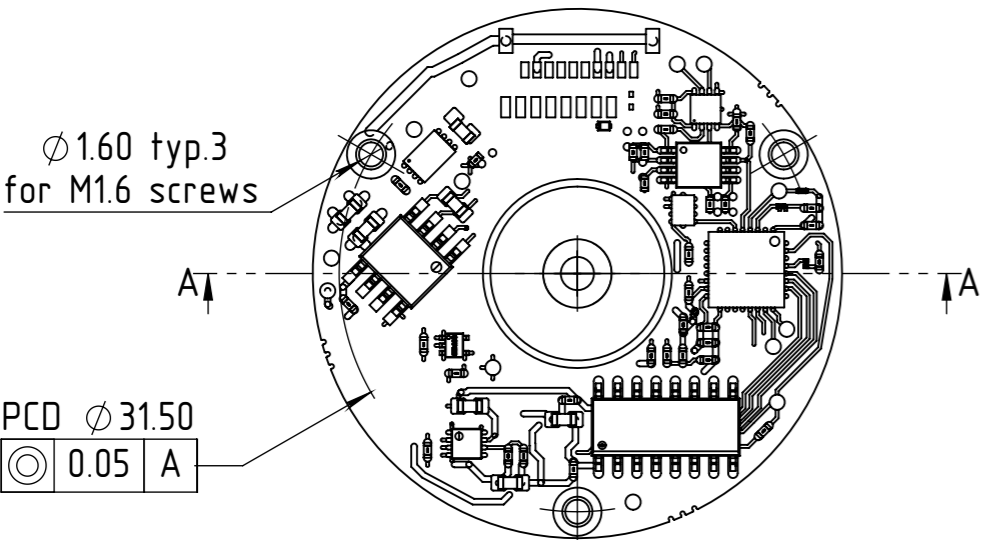

Stator mounting

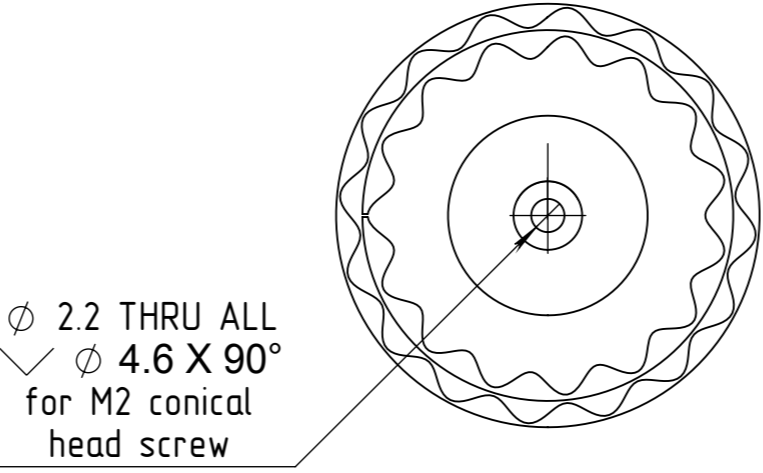

Rotor mounting

Both stator and rotor are positioned
and centered by screws only

The information contained in this drawing is the sole property of Netzer Precision Motion Sensors Ltd. Any reproduction in part or whole without the written permission of Netzer Precision Motion Sensors Ltd. is prohibited. The drawing is confidential, and is the property of Netzer Precision Ltd. It must not be disclosed to a third party without written consent of Netzer Precision Ltd.

NAME	SIGNATURE	DATE
DRAWN Michael Agam	MA	11-Apr-2024
CHK'D		
APPV'D		

UNLESS OTHERWISE SPECIFIED:
 DIMENSIONS ARE IN: mm SURFACE FINISH: N6
 0.5 - 4.9: ±0.05 mm 5 - 30: ±0.1 mm
 31 - 120: ±0.15 mm 121 - 400: ±0.2 mm
 401 - 1000: ±0.3 mm 1001 - 2000: ±0.5 mm
 Between holes: ±0.05 mm Angles: ±0.5°
 On all edges make chamfer 0.1 mm x 45°

TITLE: VLP-35-Single screw ICD

MATERIAL: Coating: SCALE: 2:1

PROJECT: VLP-35 Revision: 00 A3

CAT NO.: VLP-35-Single screw ICD SHEET 1 OF 1